

ScentStream™ SXD2110
SCENT DELIVERY SYSTEM

Installation and Operation Instructions



TABLE OF CONTENTS

- Required Tools 2
- About..... 2
- System Overview..... 3
- Installation..... 3
 - Determine Proper Mounting Location 3
 - Maximum Distance Between Assemblies 4
 - Control Unit Mounting Procedure 4
 - Duct Assembly Mounting Preparation 5
 - Duct Assembly Mounting Procedure 6
 - Collector & Bottle Mounting Procedure 6
- System Control Unit 8
 - Button Functions..... 8
 - LCD Display 8
- System Programming Tree 9
- System Set-Up..... 10
 - Set the Time & Date 10
 - Set Daylight Savings Time..... 10
- Programmed Events 11
 - Scent Intensity Screen 12
 - Review & Edit a Set Event 13
 - Delete a Set Event 13
 - Event Rules 14
 - Set Pump Speed 14
- Lockcodes 15
 - Entering Lockcode 15
- System Override - Manual Operation..... 16
- Fragrance Changeover Instructions 17
- Troubleshooting 19

REQUIRED TOOLS

- 5/32" Masonry Drill Bit
- 1/2" Drill Bit
- 1/4" Drill Bit
- 1" or 2.5cm Hole Saw
- Drill Roto/Hammer
- Pencil
- Tape Measure
- Small Level
- #1 Phillips Screwdriver/Bit
- #2 Phillips Screwdriver/Bit
- 2.5mm slotted Jewelers Screwdriver
- 1/4" Nut Driver/Bit
- 5/16" Nut Driver/Bit
- Utility Knife
- Plastic Tubing Cutters
- Flash Light
- Small Needle Nose Pliers

ABOUT

The ScentStream™ scent diffusion system is designed to deliver a dry vapor fragrance directly into the air flow of existing ventilation systems. The ScentStream™ control unit creates and controls the air pressure used to atomize the fragrance into a dry vapor. The atomization occurs in a Collector Assembly installed near the air supply duct where scent is delivered via the Duct Input Assembly. The ScentStream™ is designed to operate 1 or 2 Collector Assemblies.

SYSTEM OVERVIEW

1. Control Unit
2. 2L or 5L Fragrance Bottle
3. 25ft./7.6m - 1/4in. Air Supply Tube
4. 9ft./2.4m - 3/8in. Output Tube
5. Collector Assembly w/ 5L Recycle Tube
6. Duct Input Assembly
7. Bottle Holding Tray
8. 4x Blue Shock Absorbent Grommet
9. 8x Large Flat Washer
10. 1/4in. "Y" Quick Disconnect Fitting
11. 2L Recycle Tube
12. Barb Fitting
13. Check Valve
14. 1/4" Quick Disconnect Fitting
15. 12x #8 Plastic Drywall Anchor
16. 14x Sheet Metal Screw
17. 12x Wood / Machine Screw
18. 10x Concrete Screw
19. 6x 1/4" Retaining Clip
20. 8x Zip Tie

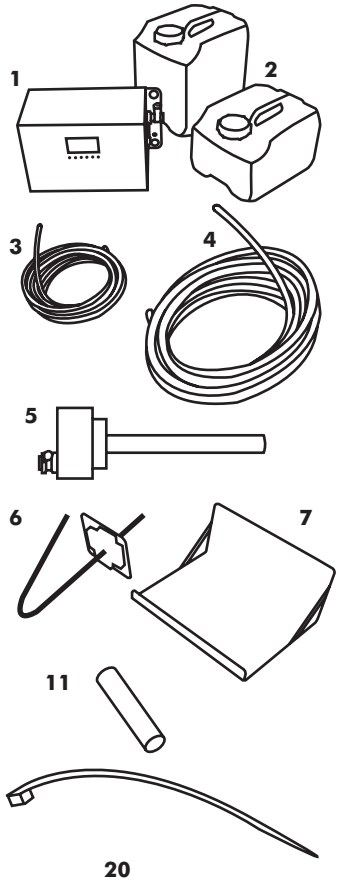

INSTALLATION

Determine Proper Mounting Location

Always review the air flow characteristics of the property before starting an installation. Most properties have well designed air flow to ensure proper heating and cooling. If air flow is such that the property is properly heated and cooled, it will then evenly distribute the scent to the same area.

Identifying which air handlers service the target area is required for proper installation. This information can come from working with property engineers, obtaining mechanical drawings of the property or completing an on-site inspection and physically locating duct runs. It is important to understand the air handlers and air duct system of the facility to avoid putting scent in areas where it is not wanted.

The ScentStream™ scent delivery system is most often installed at or near the air handler or specific duct to scent a certain area. To ensure the effective distribution of fragrance, the air handling fan must be set to run on a continuous cycle. If the HVAC fan is allowed to switch on and off (AUTO setting on thermostat), we offer an optional Pressure Sensor Kit that enables the control unit to detect whether the fan is on or off.

Maximum Distance Between Assemblies

When installing the ScentStream™ there are three (3) basic assemblies which will be permanently mounted to either a wall or the air duct. The system ships with 25ft./7.6m of 1/4IN. AIR SUPPLY TUBE to connect the CONTROL UNIT to the COLLECTOR & BOTTLE ASSEMBLY, and 9ft./2.4m of 3/8IN. OUTPUT TUBE to connect the COLLECTOR & BOTTLE ASSEMBLY to the DUCT INPUT ASSEMBLY, and 9ft./2.4m of 3/8IN. OUTPUT TUBE to connect the COLLECTOR & BOTTLE ASSEMBLY to the DUCT INPUT ASSEMBLY. Please note these tube lengths and consider them when mounting each assembly. The Collector Assembly incorporates a precision nozzle that can be effected by dust or debris. Use care to protect the tubing and the COLLECTOR AND BOTTLE ASSEMBLY from dust or debris.

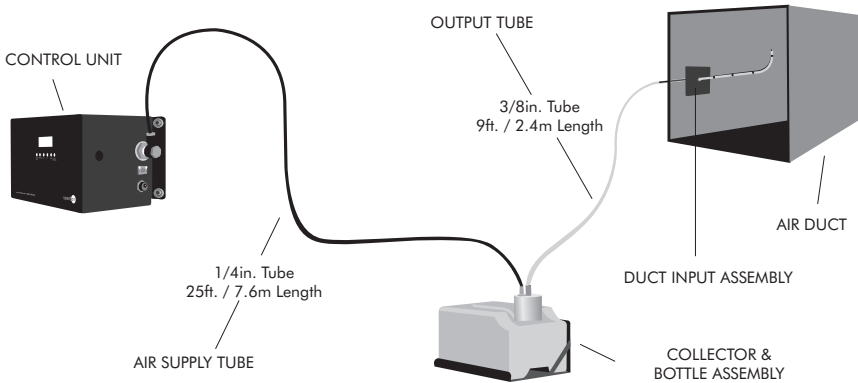

Control Unit Mounting Procedures

1. Press the blue shock absorbent grommets into the large holes on the SXD2110 bracket.
2. Determine mounting location - Consider all criteria when selecting the location:
 - The control unit should be mounted within 10 ft./3.1m of a AC outlet.
 - The control unit should be within 25 ft./7.62m of the nozzle assembly to ensure proper air pressure on the nozzle. For ease of installation and service, it is recommended that this distance be as short as possible.
 - Mount in a clean, dry space 3-6 ft./0.9-1.8m from floor for easy access.
 - Avoid locations that will collect dust. Try to keep the ScentStream hoses and power supply off the floor to avoid picking up excess dust and dirt.
3. Securing ScentStream Unit - Position pump on wall, mark hole locations and secure to wall. The ScentStream can be mounted to a wall or other structure using the provided drywall anchors and screws, or the Tapcon concrete screws. **FIG. A**

NOTE: When mounting the control unit to the wall, ensure the top of the system is level front to back and left to right.

FIG. A

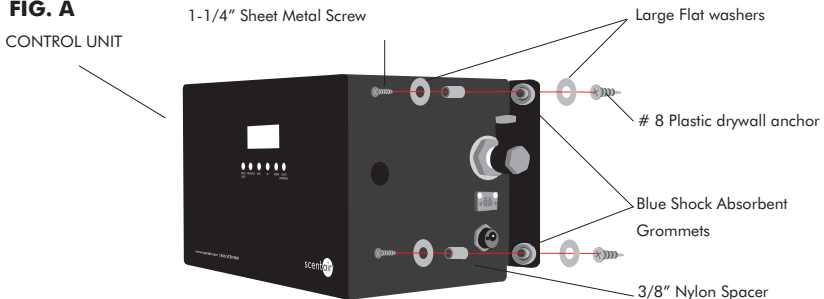

4. Use the provided zip tie with screw mount to secure power supply and excess wire to the wall.
5. Connect the 3 wire power cord to the ScentStream™ 12V power supply, and then plug the cord into an AC supply outlet. Plug the power adapter into the DC POWER IN hole on the side of the ScentStream™ unit.
6. For AIR OUT fitting, use provided 1/4" OD x 0.180" ID Nylon tubing maximum of 25ft./7.62m in length.
 - If needed use 1/4" retaining clips to secure tubing to wall attaching with appropriate hardware. This will help prevent damage to the tubing.
 - Attach the 1/4" air supply tubing to the control unit by pressing a cleanly cut end of the tubing straight into the elbow fitting on the side of the unit. Then pull back slightly to check that the tubing is locked in place. To remove the tubing from these quick disconnect fittings, just push the collar of the fitting down and pull the tubing straight out. **FIG. B**

FIG. B

CONTROL UNIT

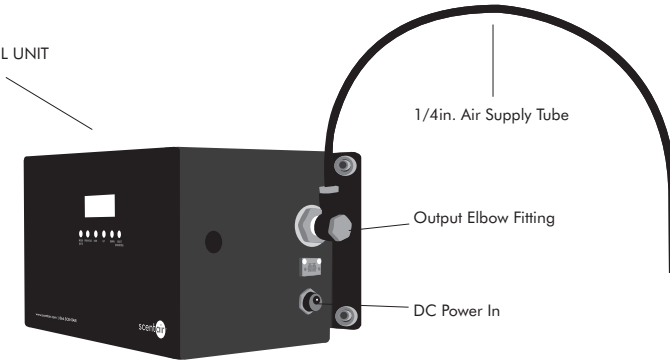

Duct Assembly Mounting Preparation

1. Insert the 3/8in. output tubing through the grommet on the duct input assembly.
2. Using the provided zip ties, attach the final 1ft. of the output tubing to the directional output mounting assembly.
3. Bend the long end of the rod in the direction of air flow and slightly up. Bend so that tip reaches to the center of the duct or as close as possible.

NOTE: Before inserting into duct, ensure that the completed assembly is on a constant ascent, with no dips and the nozzle close to the center of the air duct. Be sure not to kink the tubing. **FIG. C**

FIG. C

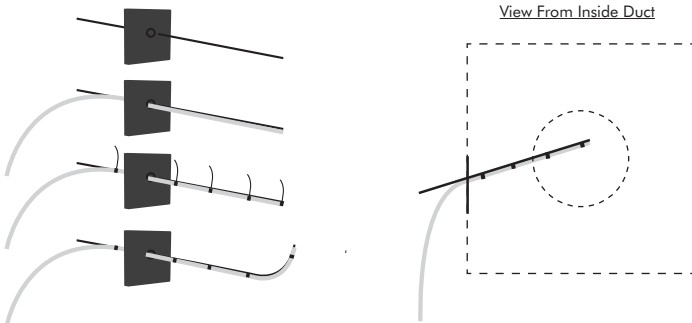

Duct Assembly Mounting Procedure

1. Determine the location on the air handler or supply duct where the Duct Input Assembly will be mounted - Be sure to consider all criteria:
 - The collector & bottle assembly will need to be mounted within 8ft./2.4m of the duct input assembly insertion point.
 - Determine which supply duct will be used for scent.
 - Determine an entry point on the bottom (preferably) or the side of the duct.
 - Make sure that the collector & bottle assembly can be mounted lower than the chosen entry point in the duct.
 - Choose an insertion point downstream of fire protection devices and heat strips.
 - Keep as much distance as possible from louvered vents.
2. Mount the Duct Input Assembly with coverplate onto air handler
 - Drill a 1 in./2.5cm hole in duct.
 - If necessary, use a screwdriver to punch through the insulation inside of the duct.
 - At the insertion point on the duct, the duct input assembly will attach to the duct with the shorter end on the outside and the longer end positioned in the airstream of the duct.
 - Insert the duct input assembly pointing in the direction of airflow. Be sure the duct input assembly is through the insulation and in the main air stream of the duct.
*Ensure that the duct input assembly will always be ascending at least slightly and never pointing downwards.
 - Make sure foam seal is in place on the duct side of the plate to prevent air leaks
 - Attach output nozzle assembly using 4 self tapping sheet metal screws.

Collector & Bottle Mounting Procedure

1. Mount the Collector & Bottle Assembly:
 - Determine the location where shelf will be mounted on wall.
 - Not to exceed 8ft./2.4m from where scent is injected into the duct.

NOTE: The collector & bottle assembly must be mounted below the entry point into the duct so that the scent delivery tube can ascend in a constant climb with no dips or sharp bends. This allows for any residual oil that might collect on the inside wall of the scent delivery hose to drain back into the collector assembly.

- Attach the shelf to the wall or air handler using appropriate hardware. **FIG. D**

FIG. D

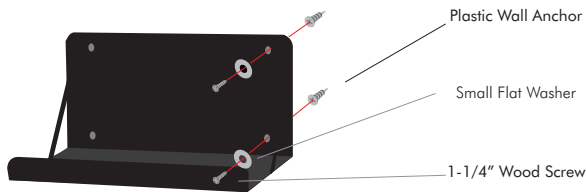

2. Attach the Collector to the Bottle:
 - Place the fragrance bottle on the shelf, and verify that it is stable.
 - Make sure the white bottle seal is in place in the underside of the collector and screw the collector assembly to the top of the bottle.
 - Carefully tighten the Collector to the Bottle making sure there is a good air-tight seal. **FIG. E**

FIG. E

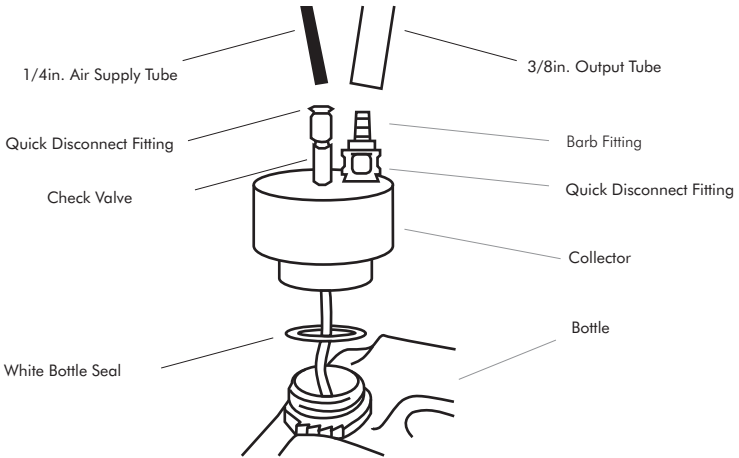

3. After mounting the Collector & Bottle assembly, the tubing must be connected to the collector.
 - To ensure that no dust or debris is in tubing, turn the control unit on to blow air through the tubing, then turn the control unit off.
 - Cut the 1/4in. Air Supply Tube from the control unit to length and press into the quick disconnect fitting.
 - Locate the plastic barbed fitting and connect to quick disconnect fitting on collector assembly.
 - Cut the 3/8in. Output Tube to length and attach to the barbed fitting on the collector.

NOTE: Make sure that the tubing descends gradually to the collector. Flat areas or “catches” will cause the system to build up excess oil in the tubing and interfere with proper operation.

NOTE: If more than one nozzle/bottle is used, split the 1/4in. air input tube from pump by using the supplied 1/4in. “Y” quick disconnect fitting. **FIG. F**

FIG. F

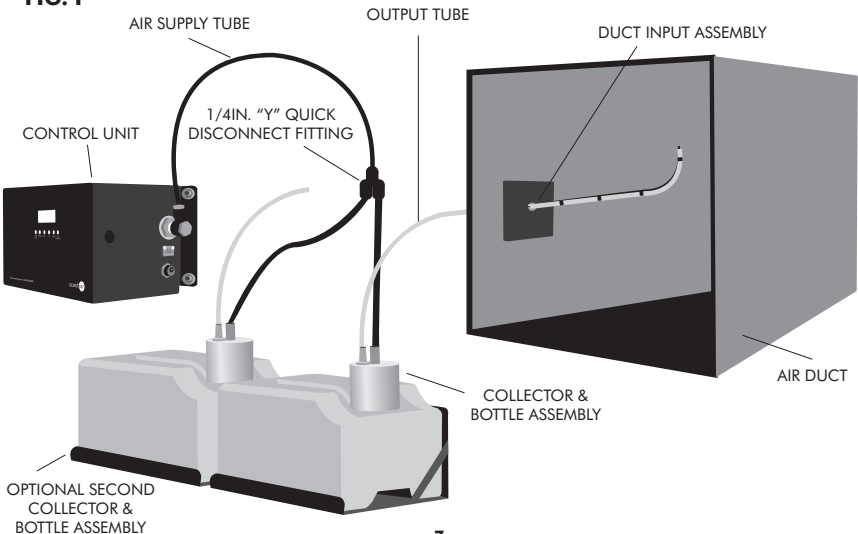

SYSTEM CONTROL UNIT

Button Functions

First, connect the SXD2110 system to the closest available power source. Check that the power supply has a lit green light indicating the system is powered.

- **MODE (EXIT)**: Moves through the seven (7) set up screens. Each setup screen has the word **"Set"** illuminated in addition to other key words that help identify which screen you are in. In order, the modes are: **Main, Set Event, Set Time, Set Pump, Set DST** and **Set Lockcode**. **MODE (EXIT)** is also used to exit a setting *without* saving changes.
- **PREVIOUS / NEXT**: Used for navigating through the setup screens and options.
- **UP / DOWN**: Push to make changes within specific setup options.
- **SELECT (OVERRIDE)**: Push to make changes at any of the setup screens, use this button to enter the edit mode for specific features. In edit mode, a number, ON/OFF toggle, or day of the week will begin to blink indicating that it can be changed with the UP and DOWN buttons. To save any changes made you must press the **SELECT (OVERRIDE)** button. Each time you save a change, the screen backlight will flash to confirm the setting was saved.

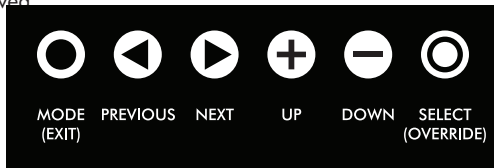

LCD Display

Pressing any button will turn the backlight on and activate the screen. The backlight must be on in order to perform any of the operations described in this manual. If left alone for two minutes, the backlight will turn off and the machine will return to the main screen. All button presses are made as "clicks". Holding down keys is never required. Once the system is turned on the first screen that will show is the main screen displaying the current time and day of the week. Below are functions commonly displayed on the screen and their purpose.

- **Auto** - Indicates that the machine is currently setup to run at specified days and times. Automatic operation can be temporarily overridden as described in section "System Override – Manual Operation".
- **ON** - Displayed during the programmed events along with the specific **Event** number at the left of the display. A circle will appear when the machine is actively emitting fragrance. **OFF** indicates that the machine has been manually switched off until the start of the next event or manual control change.
- **Lockcode** - Displayed when the controls have been protected with a password to prevent tampering. The lockcode behavior is described in "Set Lockcode".
- **HVAC** - Displayed unless optional attached sensor is indicating that the HVAC fan is off.

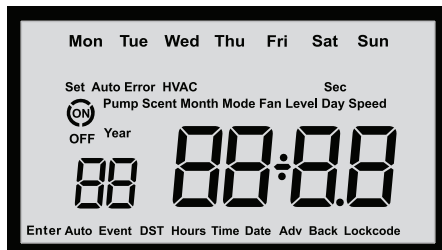

SYSTEM PROGRAMMING TREE

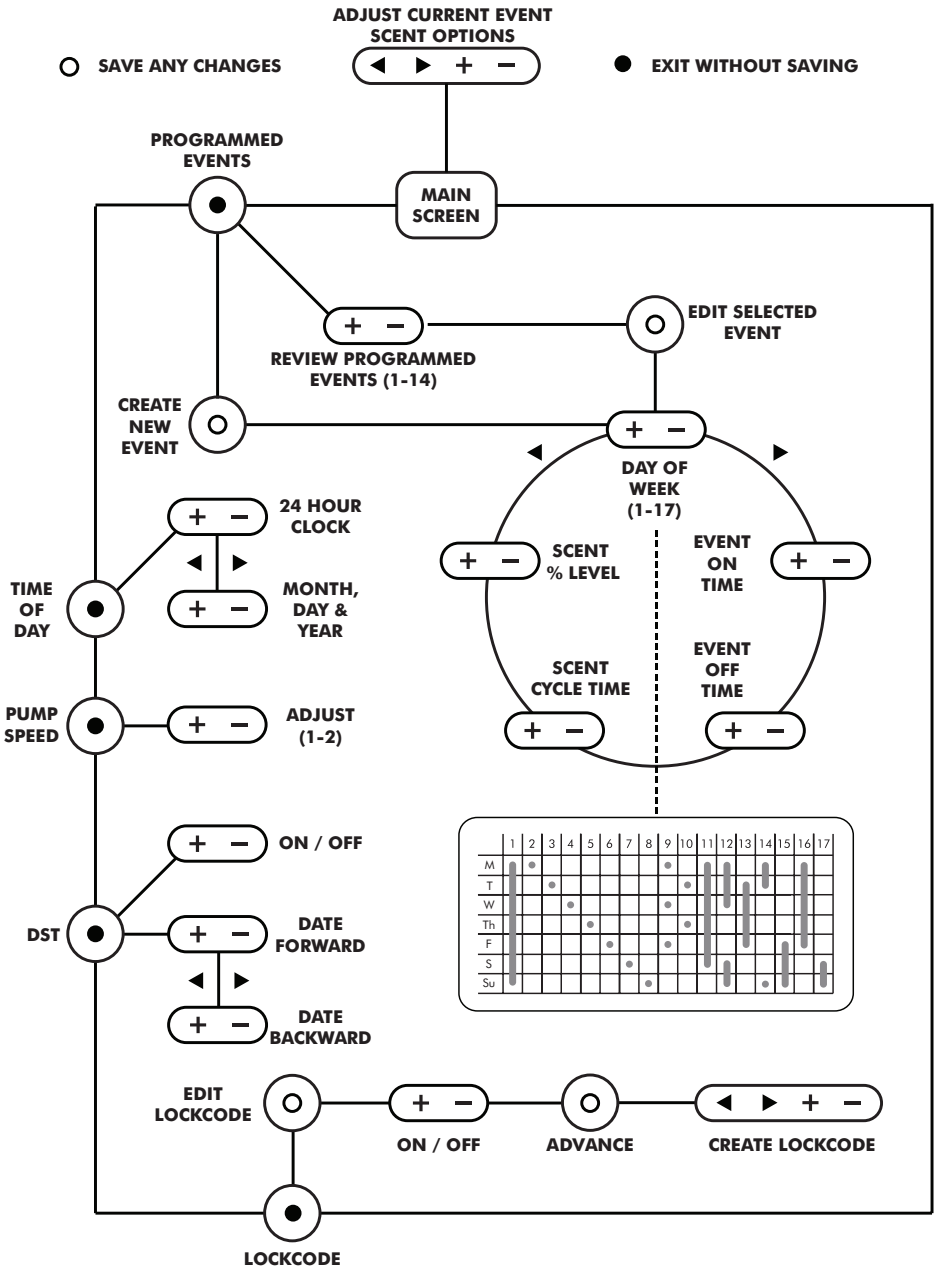

SYSTEM SET-UP

Set the Time & Date

Use the **Time** menu to change the time of day as well as the **Date**. The system uses 24-hour clock notation for all time displays, never AM/PM.

- Press any button to activate the screen if the backlight is off.
- Press MODE two times from the main screen to navigate to the **Set Time** screen, the words "**Set**" and "**Time**" will be shown on the screen.
- Press SELECT to edit the **Time**. The first selected digit will begin to blink.
- Press PREVIOUS / NEXT to navigate to each of the four digits then use UP / DOWN to change to the desired time.
- Continuing to press NEXT / PREVIOUS will change the time screen to the **Date** screen, "**Set**" and "**Date**" will be displayed. Use UP / DOWN to change to the desired Year, Day and Month.
- Press MODE at any point to discard the current changes without saving.
- Press SELECT to confirm and save the changes.



Set Daylight Savings Time

- Press any button to activate the screen if the backlight is off.
- Press MENU four (4) times from the main screen, the words "**Set**" and "**DST**" will be displayed along with the current **DST** setting; either "**OFF**" if the feature is turned off or "**ON**" and the date at which the clock will be advanced an hour. Press PREVIOUS / NEXT to review the date for the clock to be set back.
- If you are in a location with no Daylight Savings Time, press SELECT and choose "**OFF**" with UP / DOWN. Press SELECT to confirm and save the changes.
- If you are in a location that uses Daylight Savings Time, press SELECT and choose "**ON**" with UP / DOWN. Press SELECT to advance.
- The words "**Date**" and "**Adv**" will be displayed, use PREVIOUS / NEXT and UP / DOWN to set the day and month when the system should advance the clock. Press SELECT after the correct date is shown on the screen to save the setting and advance.
- The words "**Date**" and "**Back**" will be displayed, press UP / DOWN to set the day and month when the system should adjust the time back an hour.
- Press MODE at any point to discard the current changes without saving.
- Press SELECT to confirm and save the changes.

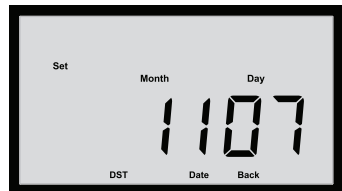

PROGRAMMED EVENTS

Use the **Event** menu to schedule programmed events to operate the system during specific hours. You may program up to 14 events each of which can be set to occur on multiple days of the week. Events can be added, deleted, reviewed, and changed from this menu.

- Press any button to activate the screen if the backlight is off.
- Press MODE once from the main screen to navigate to the **Set Event** screen, the words **"Set"** and **"Event"** will be shown on the screen. The selected event number will always be shown in this mode. Upon entering **Set Event**, the event number will be showing an 'empty' event with dashes displayed for the time.
- Press SELECT to begin editing **Event 1**. The days of the week will begin to blink.
- Press UP / DOWN to change to the desired day(s) for the event to take place. Continuing to press UP / DOWN will show various combinations of days, there are 17 options, including 7 for the individual days (Press UP first) and 10 other combinations (Press DOWN first). The default with all days flashing would create an event that is active every day of the week.
- Press NEXT to navigate to each of the four digits of the **On Time**, the words **"Set"** and **"On"** will be shown on the screen. Press UP / DOWN to set the desired **On Time**. This will be when the system will start to produce fragrance for this event.

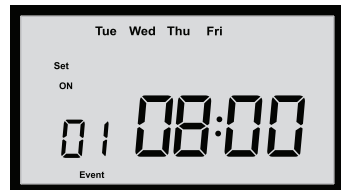
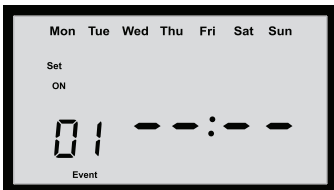

- Press NEXT to navigate to each of the four digits of the **Off Time**, the words **"Set"** and **"Off"** will be shown on the screen. Press UP / DOWN to set the desired **Off time**. This is the time that the system will end operation for this event.

NOTE: If the Off Time is earlier than the On Time the machine will understand that the event will run past midnight and turn off the next day.

- Press NEXT to navigate to the **Scent Intensity** screen for Event 1. Press PREVIOUS / NEXT to go back and forth between any of the settings for the current event. More information on **Scent Intensity** can be found on the next page.



- Press SELECT to accept all current event settings and return to the Main screen. The display screen backlight will blink to indicate the event was saved OR display **"Error"** if there was a problem with the event times.
- Press MODE at any point before pressing SELECT to discard MODE the current changes and return to the review of existing events.

NOTE: If error was displayed the system will remain in edit mode so the current event can be corrected without losing any of the information already entered.

NOTE: After saving an event the system will automatically display the next empty event number, so multiple new events can be added one after another with minimum effort.

Scent Intensity Screen

The ScentStream™ regulates the output of fragrance by cycling on and off, so that just the right level of fragrance can be obtained in your space. Below are in-depth descriptions of scent output options available for adjustment.

- **SCENT TIME** - This defines the interval period in minutes for each cycle from when the system turns on through the rest period to the next turn on. This can be adjusted in increments of one (1) minute up to ten (10) minutes. As the **Scent Time** increases, the amount of fragrance in the air will have time to change by a greater amount as the machine cycles on and off.
 - **LONG Scent Time:** Setting longer times can help ensure that the fragrance is noticed in an environment where customers might stay for longer periods by counteracting the natural tendency to become used to a scent over time.
 - **SHORT Scent Time:** Setting shorter scent times is best used to keep the level of fragrance consistent in a space where the customers will be crossing in and out of the space frequently, such as a hall or entrance way.



- **SCENT LEVEL** - This adjusts the fragrance intensity by increasing or decreasing the average level of fragrance from 5% to 95%. The higher the number the more intense the fragrance will be. The total amount of fragrance delivered over an entire event will be the same if the level is the same, regardless of the **scent time** setting. Keep in mind that the **scent levels** may need to be adjusted after a time to achieve the desired effect. The ScentStream™ will allow you to adjust the **scent levels** without having to re-enter any of the time information.



Review & Edit a Set Event

- Press any button to activate the screen if the backlight is off.
- Press MODE once from the main screen, the words "Set" and "Event" will be shown on the screen. The selected **Event** number will be shown in this mode.
- Press UP / DOWN to cycle through the stored **Event** numbers. The **On Time** will be displayed for each of them in turn.
- Press PREVIOUS / NEXT to switch between the **On Time**, **Off Time**, **Scent Time** and **Scent Level** information for each **Event**. While reviewing the **Event** information the days of the week will be displayed for both **On Time** and **Off Time**, making events that run past midnight easier to keep straight.



NOTE: The event numbers may have changed since they were originally entered, as the list is automatically sorted when events are added and erased so that the highest event number is always event.

- Press SELECT to edit the currently selected event. This will cause one of the fields to blink and allow you to make any changes desired. Use PREVIOUS / NEXT to switch between all of the data fields.
- Press MODE at any point to discard the current changes without saving.
- Press SELECT to confirm and save the changes.

Delete a Set Event

- Press any button to activate the screen if the backlight is off.
- Press MODE once from the main screen, the words "Set" and "Event" will be shown on the screen. The selected **Event** number will be shown in this mode.
- Press UP / DOWN to cycle through the stored **Event** numbers.
- Set the **On Time** and **Off Time** to be the same. Pressing SELECT at this point will delete this event.

NOTE: Press UP & DOWN at the same time to simultaneously set the **On Time** and **Off Time** to 00:00, providing an easy shortcut to delete events rapidly.

- Press MODE at any point before pressing SELECT to discard the current changes and return to the review of existing events.



Event Rules

The ScentStream™ allows combinations of events with different scent intensity, scent time and scent level. An event can occur inside another event, for instance, you could establish a low scent level for the entire workday MON - FRI from 08:00-17:30 hours as Event 1, then add Event 2 with a high scent level during your busiest hours on MON from 14:00-16:30 hours.

It is NOT possible to save an event that overlaps an existing event or has the same start or stop times. If you have an event that runs every day from 21:00 to 05:00 the next morning, you cannot add an event that runs from 04:00 to 15:00, because it overlaps and would not clearly define the scent levels for the overlap. The display screen backlight will display **"Error"** if there was a problem with the event times. If error was displayed the system will remain in edit mode so the current event can be corrected without losing any of the information already entered.



Set the Pump Speed

This menu allows the **Pump Speed** to be adjusted between two settings. This allows for dual collector settings. The **Pump Speed** will be the same for all fragrance events.

- Press any button to activate the screen if the backlight is off.
- Press MENU three (3) times from the main screen, the words **"Set"**, **"Pump"** and **"Speed"** will be displayed along with the current pump speed value. Press SELECT to edit the setting. This will cause the **Pump Speed** field to blink. Press UP / DOWN to adjust the amount from 1 or 2.
- Press SELECT to confirm and save the changes or press MENU to discard any changes.

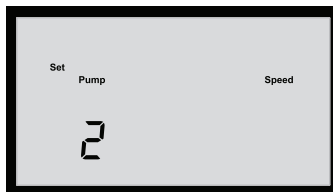

LOCKCODES

In this menu you can select a four digit lockcode that will prevent changes from being made to the settings by unauthorized users.

- Press any button to activate the screen if the backlight is off. Press MODE six (6) times from the main screen, the words "Set" and "Lockcode" will be displayed along with the current **Lockcode** setting; either "**OFF**" if the feature is turned off or "**ON**" and the current Lockcode being used.
- Press SELECT to edit the lockcode screen and press UP to change the setting to "on"
- Press SELECT to advance to the next screen, use PREVIOUS / NEXT to choose between the blinking digits to be edited, use UP / DOWN to choose the desired digit of 0-9
- Press SELECT to save the lockcode to the system.



NOTE: Once a lockcode is set to "ON" the machine will be automatically locked two (2) minutes after any authorized operation. When lockcode is displayed at the main screen pressing any key will bring up the enter lockcode screen described below. If you forget your lockcode please contact ScentAir.

Entering a Lockcode

- Press any button to activate the screen if the backlight is off.
- The words "Enter" and "Lockcode" will be displayed along with 4 zeros with the first one blinking.
- Press PREVIOUS / NEXT, and UP / DOWN to enter the correct 4 digit code.
- Press SELECT to enter the digits selected.

NOTE: If the code is invalid "Error" will be displayed and you can try again to enter a valid code. If the code is correct the display will return to the main display, and all buttons and settings will be accessible temporarily.



SYSTEM OVERRIDE – MANUAL OPERATION

Pressing SELECT while the system is operating during a programmed event will temporarily stop the system, displaying **Auto**, **HVAC**, **OFF** and the current Day of the Week and Time. Pressing SELECT when the system is not running will turn it **ON** using the last setting. Automatic operation will resume at the start of the next event.

You may also check the current **Scent Levels** or temporarily change the **Scent Time** and **Scent Level** during a running programmed event. Press PREVIOUS / NEXT or UP / DOWN to view or edit the current scent settings displayed with the **Scent Time** blinking. Press SELECT to save any changes or MODE to exit without saving.

While the machine is in auto mode the changes will only work for the duration of the current event. Permanent changes to events must be made from the **Set Event** menu as described above under "Reviewing, Editing and Deleting a Previously Set Event".

If no events are running ("**Auto**" not displayed) you may press the SELECT button to activate the system and start atomizing fragrance in always on mode. The screen will show the word "**ON**" but not "**Auto**". This special run state will be active, even if power is disconnected from the machine, until events are added or the machine is switched off by pressing the SELECT button again from the main display.

FRAGRANCE CHANGEOVER INSTRUCTIONS

The following procedure should be followed whenever a ScentStream™ system is to be changed from one fragrance to another in order to minimize any undesirable mixing of the two scents.

Materials needed:

- One bottle (5L) of new fragrance sealed with screw cap
- One bottle partially filled (200ml) with clear cleanout liquid (DPG) from ScentAir (never use water) also sealed with screw cap
- Paper towels

These instructions are written so that the collectors can be in their as installed location during the cleanout process. If the duct insertion points or mounting locations need to be changed as well please refer to the installation guides for the ScentStream™ for detailed instructions.

It is recommended to have the ScentStream™ machines switched off for a few hours before doing the change out. In any case allow at least 20 seconds after switching machine off before removing the collector from the bottle.

1. Disconnect the 12V power supply from the ScentStream™ pump unit to ensure that it is switched off during the bottle change. DO NOT change any of the controls at this time.
2. At the first collector associated with the system, disconnect the air in tubing from the Quick Disconnect Fitting on the top of the collector by pressing in on the collar while pulling the tube straight out upwards.
3. Now remove the fragrance output tube by depressing the metal release on the plastic fitting and pulling the tube attached to the metal coupler straight up. Once removed use a paper towel to catch any drips from the bottom of the fragrance tube.
4. Unscrew and remove the collector from the bottle of old fragrance oil, being careful to catch any drips with the paper towels. If the bottle was relatively full pause with the tubes at the bottom of the collector above the surface of the liquid to drain for a few moments before removing from the bottle completely.
5. Temporarily set the collector down on its side on a clean surface, do not touch or allow the white tubing at the collector bottom to contact any surface, it must stay clean.
6. Take down the bottle of used fragrance oil and put the bottle of cleanout liquid in its place.
7. Screw the collector onto the cleanout liquid bottle firmly.
8. Re-attach the air supply tubing by pressing straight into the QD fitting.
9. Re-attach the fragrance output tubing by pressing straight into the fitting until it clicks.

IF THIS IS THE ONLY COLLECTOR REQUIRING A FRAGRANCE CHANGE CONNECTED TO THIS SXD2110 PUMP UNIT SKIP TO STEP 17

10. Take the used bottle of fragrance oil with you and proceed to the next collector attached to the ScentStream™ .
11. At the next collector associated with the ScentStream™ system disconnect the air in tubing from the QD fitting on the top of the collector by pressing in on the collar while pulling the tube straight out upwards.
12. Now remove the fragrance output tube by depressing the metal release on the plastic fitting and pulling the tube attached to the metal coupler straight up. Once removed use a paper towel to catch any drips from the bottom of the fragrance tube.
13. Unscrew and remove the collector from the bottle of old fragrance oil, being careful to catch any drips with the paper towels. If the bottle was relatively full pause with the tubes at the bottom of the collector above the surface of the liquid to drain for a few moments before removing from the bottle completely.

14. Temporarily set the collector down on its side on a clean surface, do not touch or allow the white tubing at the collector bottom to contact any surface, it must stay clean.
15. Transfer all the used oil into one of the used bottles, then screw the collector at this location back onto an empty bottle
16. Re-attach both of the tubes to this collector by pressing them straight in until they seal.
17. If there are additional collectors attached to the same ScentStream™ repeat steps 10-16 until all the used oil has been gathered into one bottle and all the collectors are attached to the system and in empty bottles.
18. Return to the ScentStream™ control unit. Note that all air supply tubes should be attached to collectors so that the system can be pressurized.
19. If the optional duct sensor (with green connector) is plugged into the ScentStream™ near the power jack, unplug it now (2 small screws may be holding the connector in place if it does not pull out easily).
20. Re-attach the DC power plug to the ScentStream™ control unit. If the machine is set to timer or **ON** mode the pump will come on. If not remember the setting and move the switch to **ON** now.
21. Using the set button check and record the **ON** and **OFF** cycle times for the machine, if the **ON** time is less than 3 minutes write down the current setting and adjust it upwards to at least 3 minutes. Record the current **OFF** time setting and adjust it downwards to 10 seconds. This will make the pump run most of the time.
22. Record the setting of the Nozzle mode switch and move it to the highest setting
23. Return to the first collector (with the cleanout liquid bottle).
24. Remove the fragrance output tube and verify (with a flashlight) that atomized vapor is exiting the top of the collector as pressure is supplied. If it is not, try tilting the bottle so that the liquid level is higher under the collector.
25. Replace the output tube and allow it to atomize for at least 3 minutes.
26. Remove the tubing from the top of the collector.
27. Remove the collector from the cleanout bottle, allow it to drain for a minute or so before installing the collector on top of the new fragrance bottle.
28. Reattach all tubing, and check that the fittings on the collector are properly finger tight, and that the collector is firmly screwed onto the new bottle.
29. Take the Cleanout bottle with you to the next collector in the system and repeat steps 3-8 and 24-28 for each collector in turn.
30. Return to the ScentStream™ control unit and change all settings back to their original values.
31. Reinstall the duct sensor connector if it was installed.
32. Unplug the power connector and replace it one last time.
33. All the collectors should be connected to new bottles of fragrance. Replace the bottle caps on the empty bottles and collect tools before leaving.

TROUBLESHOOTING

PROBLEM	SOLUTION
Unit will not turn on	<ul style="list-style-type: none"> • Make sure power is running to the system is via a working outlet • Press SELECT (OVERRIDE) on the system. If unit turns on, then reset clock event settings. • If backlight turns on and there is no information on the LCD display, the LCD is malfunctioning • If unit still will not run replacement will be necessary.
Pump does not run (If unit has a pressure switch)	<ul style="list-style-type: none"> • Unplug the DC power plug from the jack on the SXD2110 control unit, then plug back in • If pump stops immediately after restarting there may be a clog in the pressure line, try again with tubing disconnected, and check collector nozzle for obstructions. • If pump will not stay on, unit will need to be replaced. • Unplug phoenix connector from machine • If unit still does not work, refer to above • If unit runs check fan to see if the fan is running on the HVAC system • If fan is running, ensure pressure switch entry location is far enough downstream from duct changes: reduction, enlargement, turn, split, etc. • If both the fan is on and the pressure switch probe is located in the correct position, check the switch by blowing into the probe. If the switch “clicks” there may not be enough airflow in system for activation. • If there is no audible “click”, replace switch. Be sure to not move switch as this can cause a false start.
Cannot smell scent	<ul style="list-style-type: none"> • Make sure pump is running and is set to the proper # of nozzles. • Confirm an event is set with timer set for the unit to run at the current times of the day. • Check for oil in the container. • Make sure pump is on. Detach 3/8in. Output Tube from Collector by pressing metal tab on fitting and pulling straight up to release. • If no mist is seen the bottom half of the nozzle or the pickup tube is clogged, a small strip of wire can be used to clear obstruction. If that does not work replacement will be necessary. • Make sure 3/8in. Output Tube on the discharge side of collector is mounted in the correct supply duct and is clear without any dips or traps. • Make sure all dampers are open in the HVAC duct and the HVAC system fan is on.

For further assistance please contact Technical Services at:
704.504.2320
techservices@scentair.com